

Dichtschauben

Produktübersicht

JA2/JB2/JZ2

JA3/JB3/JZ3

JA1/JZ1
CORREMAKS®

JZ5

Dichtschauben
mit Zapfen oder Spitze



Werkstoff

Stahl einsatzvergütet,
korrosionsschutz

Edelstahl A2

Edelstahl A8

Edelstahl A2
mit gehärteter
Gewindefurchzone

für Bauteile aus

Stahl/Aluminium/Holz

Stahl/Aluminium/Holz

Stahl/Aluminium/Holz

Stahl/Aluminium

Aluminiumblech, Aluminium-Strangpressprofil*

Bauteildicke t_{II} [mm]	bis 0,9	1,0–1,4	1,5–2,9	3,0–4,9	≥ 5,0
Bohrloch-Durchmesser [mm]	4,0	4,0	4,5	5,0	5,3
EJOT Schraube Typ	JA Ø 6,5 / JB Ø 6,3			JZ Ø 6,3	

* Bei Verschraubung von Aluminiumprofilblechen (Bauteil I) auf Unterkonstruktionen aus Stahl (Bauteil II) gelten die Bohrloch-Durchmesser der Tabelle für Stahlunterkonstruktionen

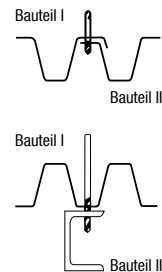

Stahlunterkonstruktionen gemäß ETA

Bauteildicke t_{II} [mm]	0,63	0,75	0,88	1,00	1,13	1,25	1,50	2x 0,75	2x 0,88	2x 1,00	1,25–1,9	2,0–5,9	6,0–6,9	7,0–9,9	≥10,0	1,5–5,9	6,0–7,9	8,0–9,9	≥10,0
Bohrloch-Durchmesser [mm]	3,5	4,0	4,5	4,5	4,5	4,5	5,0	4,5	5,0	5,0	5,0	5,3	5,5	5,7	5,8	6,8	7,0	7,2	7,4
EJOT Schraube Typ	JA Ø 6,5 / JB Ø 6,3										JZ Ø 6,3				JZ Ø 8,0				

Holzunterkonstruktionen gemäß ETA

Bohrloch-Durchmesser [mm]	3,4	3,6	4,5
EJOT Schraube Typ	JA Ø 4,9	JA Ø 6,0	JA Ø 6,5

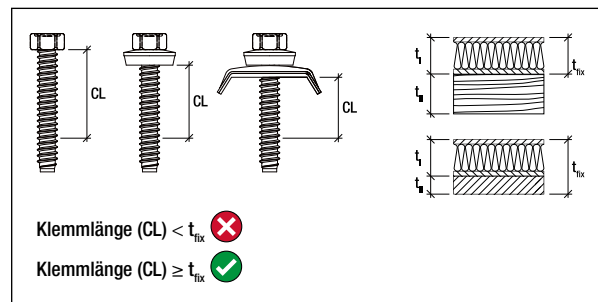

Hinweise



Z-14.4-901
Z-14.4-426
Z-50.4-337
Z-10.3-833



ETA-10/0200
ETA-13/0177
ETA-22/0126
ETA-24/0547



Fachregeln des
Metalleichtbaus (IFBS)



Augenschutz benutzen



Bis zur Montage trocken lagern

Dichtschrauben

Montageablauf (Beispiel 1)

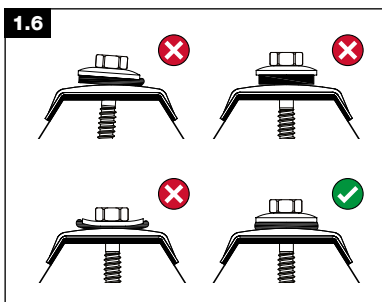
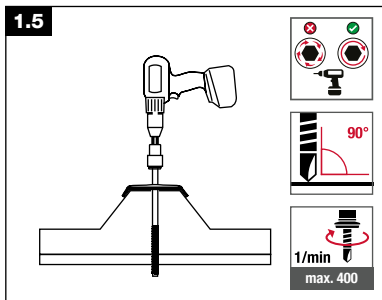
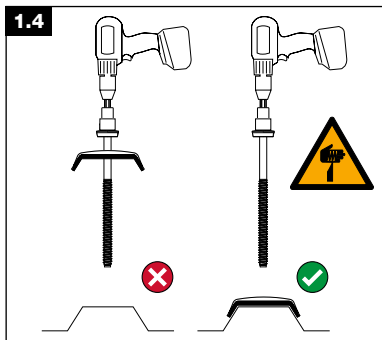
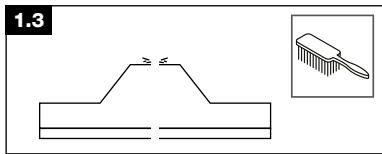
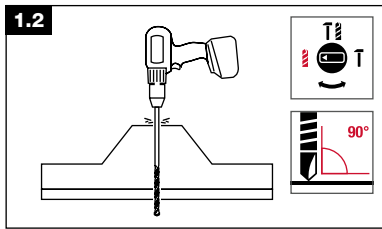
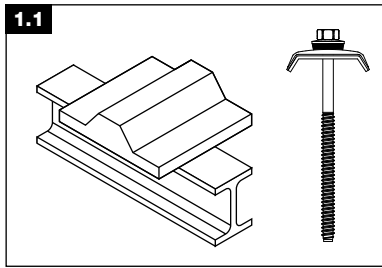

Montageablauf (Beispiel 2)

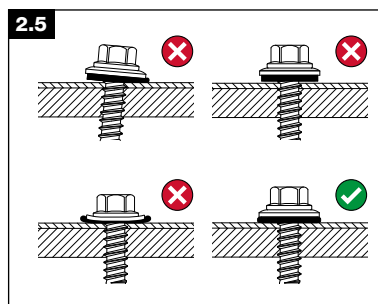
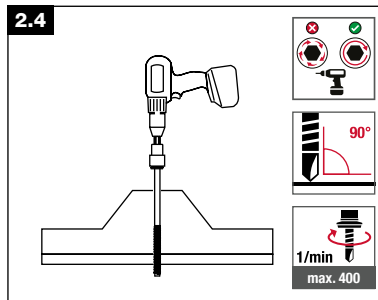
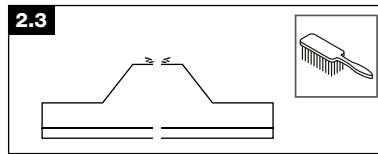
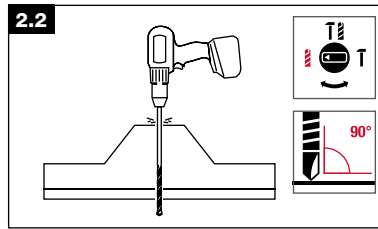
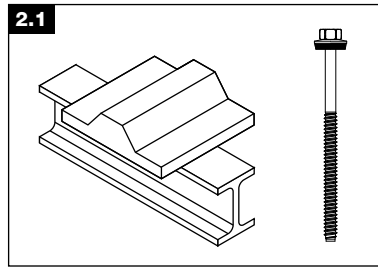

Montageablauf (Beispiel 3)

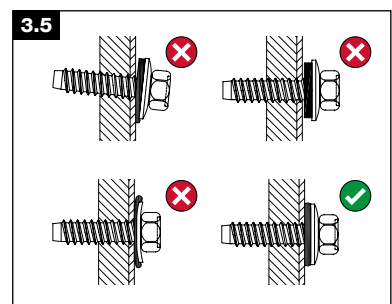
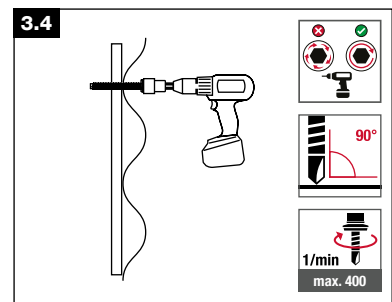
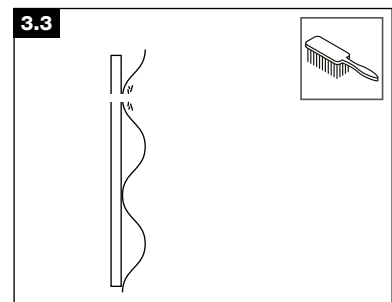
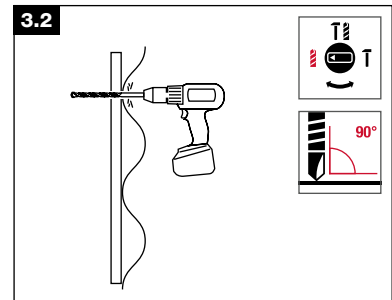
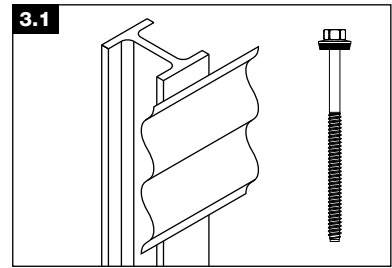

Self-tapping screws

Product overview

JA2/JB2/JZ2

JA3/JB3/JZ3

**JA1/JZ1
CORREMAKS®**

JZ5

Self-tapping screws with dog point or point



Material

Steel case-hardened, corrosion-protected

A2 stainless steel

Stainless steel HCR (1,4529)

A2 stainless steel with hardened thread forming zone

For components made of

Steel/aluminium/timber

Steel/aluminium/timber

Steel/aluminium/timber

Steel/aluminium

Aluminium sheet, aluminium extrusion profile*

Component thickness t_{II} [mm]	bis 0.9	1.0–1.4	1.5–2.9	3.0–4.9	≥ 5.0
Drill hole diameter [mm]	4.0	4.0	4.5	5.0	5.3
EJOT screw type	JA Ø 6.5 / JB Ø 6.3			JZ Ø 6.3	

* When fastening profiled aluminium sheet (component I) to steel substructures (component II) the drill hole diameters from the chart for steel substructures apply

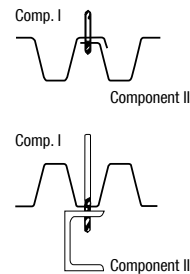

Steel substructures according to ETA

Component thickness t_{II} [mm]	0.63	0.75	0.88	1.00	1.13	1.25	1.50	2x 0.75	2x 0.88	2x 1.00	1.25–1.9	2.0–5.9	6.0–6.9	7.0–9.9	≥10.0	1.5–5.9	6.0–7.9	8.0–9.9	≥10.0
Drill hole diameter [mm]	3.5	4.0	4.5	4.5	4.5	4.5	5.0	4.5	5.0	5.0	5.0	5.3	5.5	5.7	5.8	6.8	7.0	7.2	7.4
EJOT screw type	JA Ø 6.5 / JB Ø 6.3										JZ Ø 6.3				JZ Ø 8.0				

Wooden substructure according to ETA

Drill hole diameter [mm]	3.4	3.6	4.5
EJOT screw type	JA Ø 4.9	JA Ø 6.0	JA Ø 6.5

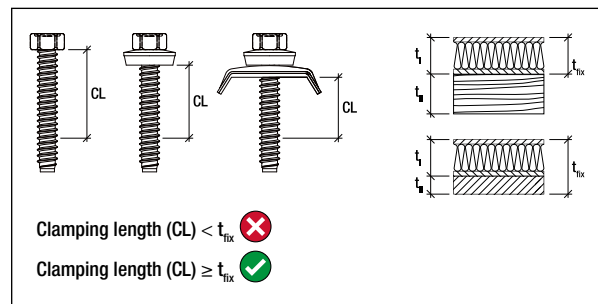

Notes



Z-14.4-901
Z-14.4-426
Z-50.4-337
Z-10.3-833



ETA-10/0200
ETA-13/0177
ETA-22/0126
ETA-24/0547



Rules of lightweight metal construction (IFBS)



Eye protection must be worn



Store dry until installation

Self-tapping screws

DE

EN

Assembly process (example 1)

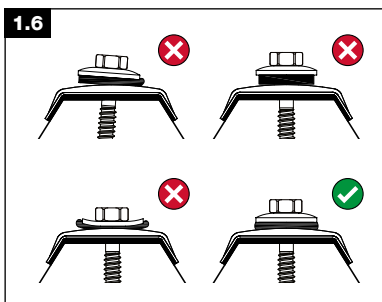
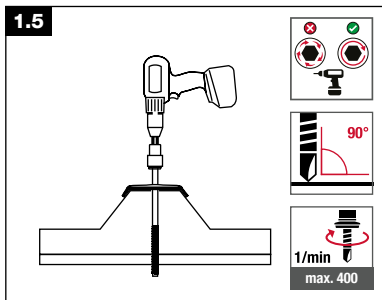
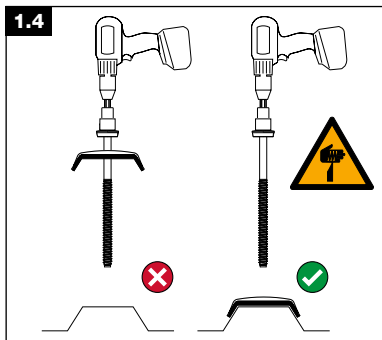
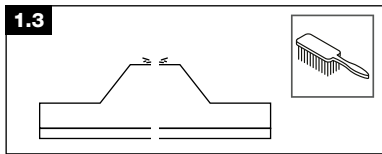
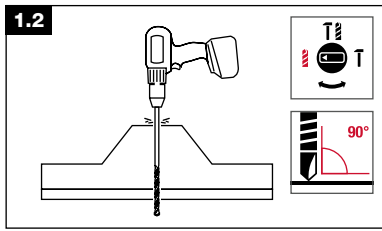
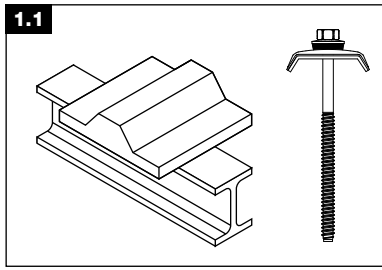

Assembly process (example 2)

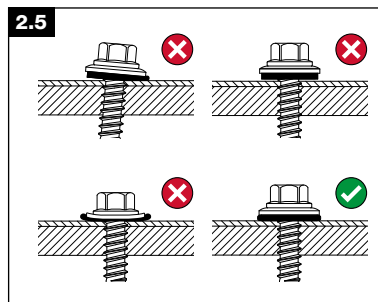
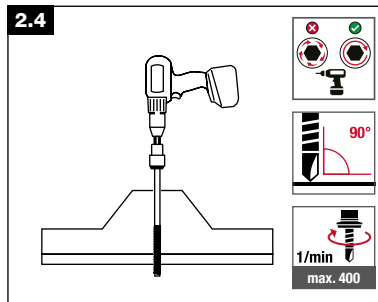
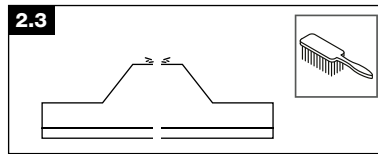
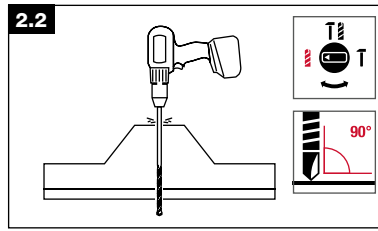
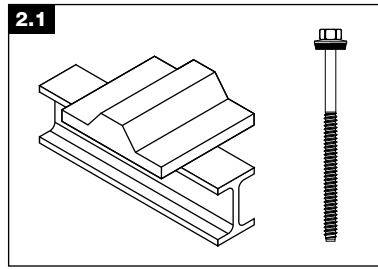

Assembly process (example 3)

